

GROUP F

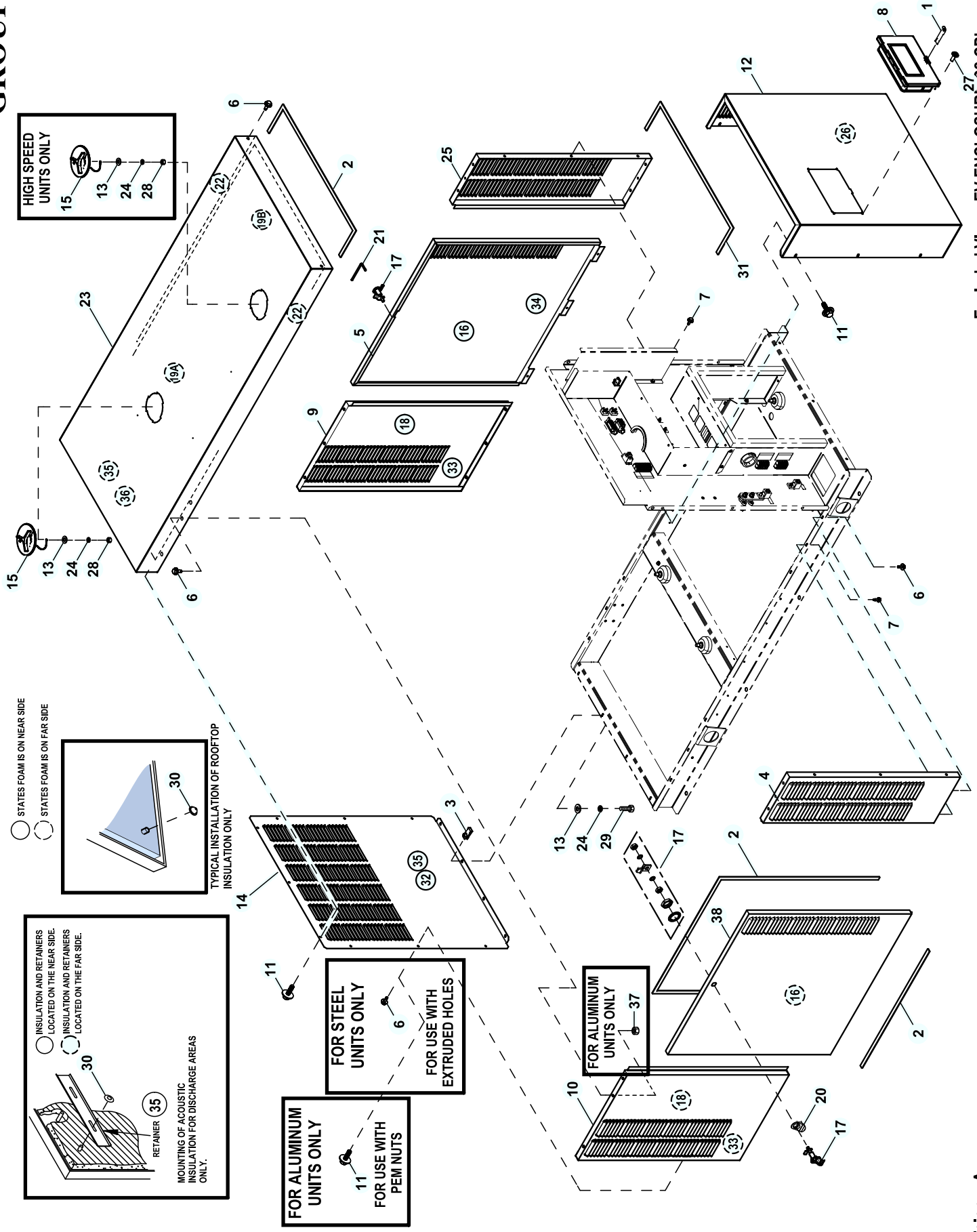

EXPLODED VIEW: EV ENCLOSURE C2 CPL

DRAWING #: 10000006690

GROUP F

ITEM	PART#	QTY.	DESCRIPTION
1	OK4322	1	EYE HASP CUST ACCESS BOX
2	OE5968	1	GASKET, EXTRUDED TRIM (327.0"LG)
3	0H0412	4	NUT U M6-1.0 GEOMET
(1)4	10000004801	1	ST0R PANEL REAR LEFT C2 CPL
(1)5	10000004783	1	ST0R SIDE DOOR RIGHT C2 CPL
(2)(3)6	OC2454	21 / 16	SCREW HWHT M6-1 X 16 N WA Z/JS
(2)7	OE3257	15	SCREW HWHTF M6-1.0 X 16
8	OK3386	1	CUSTOMER ACCESS ASSEMBLY
(1)9	OK40090ST0R	1	FRONT RIGHT CORNER C2
(1)10	OK40100ST0R	1	FRONT LEFT CORNER C2
(3)11	OK8641	9 / 14	SCREW HHFC M6-1.0 X 20 NYL WA
(1)12	OK37870AL0R	1	PANEL CENTER REAR C2 CPL_
(5)13	022473	5 / 6	WASHER FLAT 1/4-M6 ZINC
(1)14	OK65230AL0R	1	FRONT COVER ENCLOSURE C2
(5)15	0F4487	1 / 2	ACCESS COVER
16	OK2671	2	INSUL DOOR C2 D3.4L
17	0F5048D	2	WISE-ACTION LATCH, SLOTTED CIR
18	OK2671B	2	INSUL CORNER POST C2 D3.4L
19	0L3103	1	KIT INSULATION C2
19A	0G5892A	1	INSULATION ROOF TOP
19B	0G5892F	1	INSULATION ROOF TOP
20	0F5049B	2	PULL TAB DOOR LOCK ST
21	0F8869D	1	KEY VISE-ACTION LATCH SLOT CIR
22	OK2671E	2	INSUL ROOF SIDES C2 CPL
(1)23	OK6524AAL0R	1	ROOF C2 AL HIGH SPEED
	OK65240AL0R	1	ROOF C2 AL
(5)24	022097	5 / 6	WASHER LOCK M6-1/4
(1)25	10000004766	1	ST0R PANEL REAR RIGHT C2 CPL
26	OK2671C	1	INSUL FRONT C2 D3.4L
27	0J7751	4	SCREW PPHTF #10-16 X 1/2 B
(5)28	022127	1 / 2	NUT HEX 1/4-20 STEEL
29	080318	4	SCREW HHFC M6-1.0 X 25 FTH G8
30	078115A	12	WASHER SELF LOCKING DOME #8-32
31	066760	1	STRIP SEALANT 1/8 X 1
32	OK8973	1	INSULATION
33	0D3059E	2	FOAM,BACK EXHAUST ENCL COVER
(4)34	0E5298L	1	FOAM 300 X 300 THERMAL ACO
35	0F3890A	4	RETAINER INSULATION (740)
36	0F4051C	1	INSULATION DUCT
37	077992	26	NUT HEX LOCK M6-1.0 SS NY INS
(1)38	10000004810	1	ST0R SIDE SOOR LEFT C2 CPL

NOTES (UNLESS OTHERWISE SPECIFIED):

(1) SHEET METAL PARTS LISTED IN THE BOM TABLE ARE REPRESENTING GENERIC PARTS (NO COLOR)

- MANUFACTURING: FOR CORRECT MATERIAL AND COLOR REFER TO XA BOM.
- CUSTOMER: WHEN ORDERING REPLACEMENT PARTS ENTER BASE NUMBER (FIRST 6 DIGITS ONLY) IN THE SYSTEM FOR CORRECT MATERIAL AND COLOR (FOR REFERENCE SEE GUIDELINE 0H7169).

(2) ENCLOSURE NOTE: PANELS THAT FASTEN TO THE BASEFRAME MUST BE SECURED USING I/N 6 & 7 (THREAD FORMING FASTENERS). ALL PANEL TO PANEL CONNECTIONS TO INCLUDE AT LEAST ONE CONNECTION POINT USING I/N 7 (THREAD FORMING FASTENER).

(3) QTY. REQUIRED FOR STEEL UNITS / QTY. REQUIRED FOR ALUMINUM UNITS.

(4) USED ON 48 & 60 KW UNITS ONLY.

(5) QTY. REQ. FOR 32, 38 & 45KW / QTY. REQ. FOR 36, 45 & 60KW.

(6) USED ON ALUMINUM UNITES ONLY.