

GROUP D

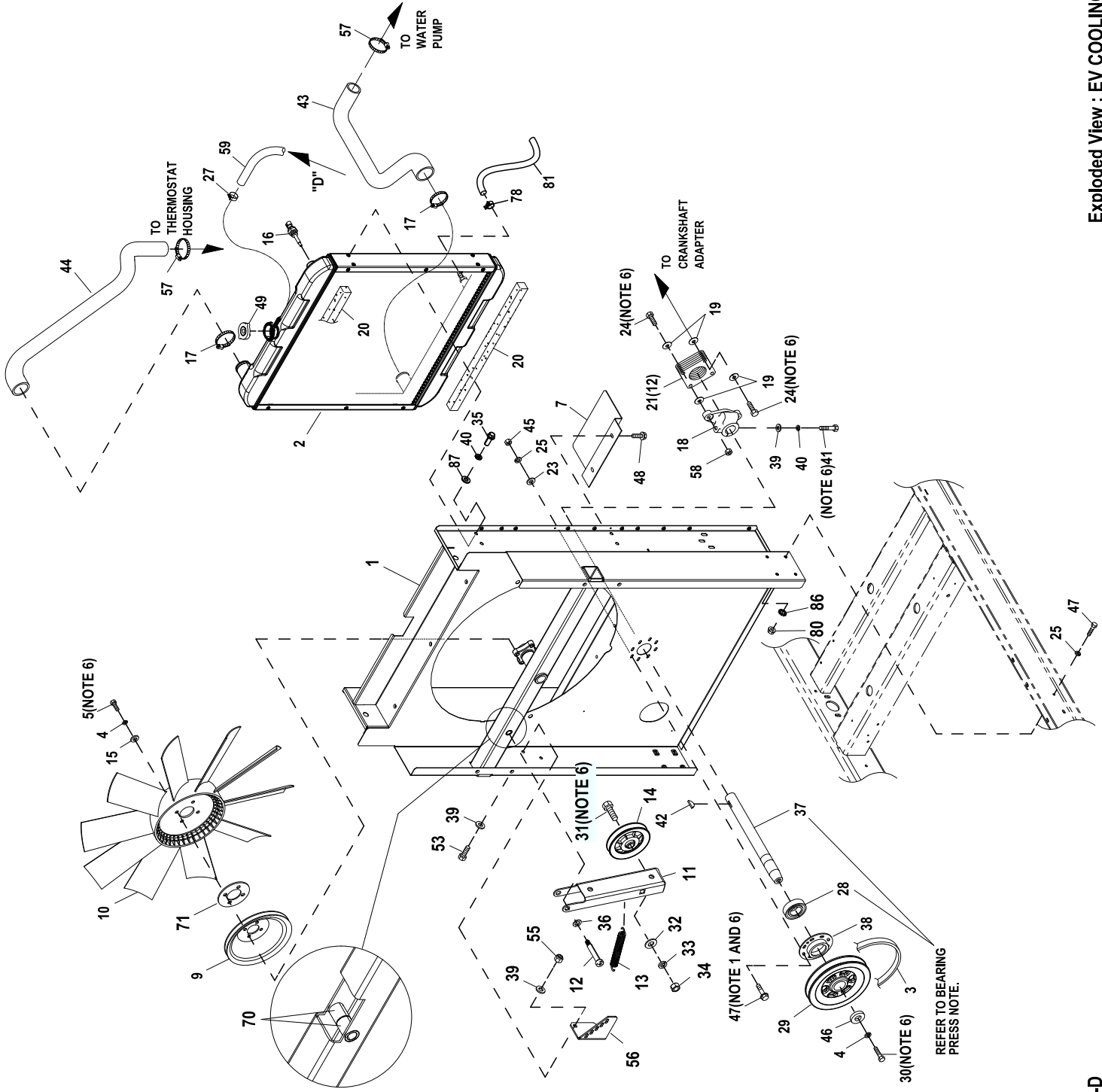

GROUP D

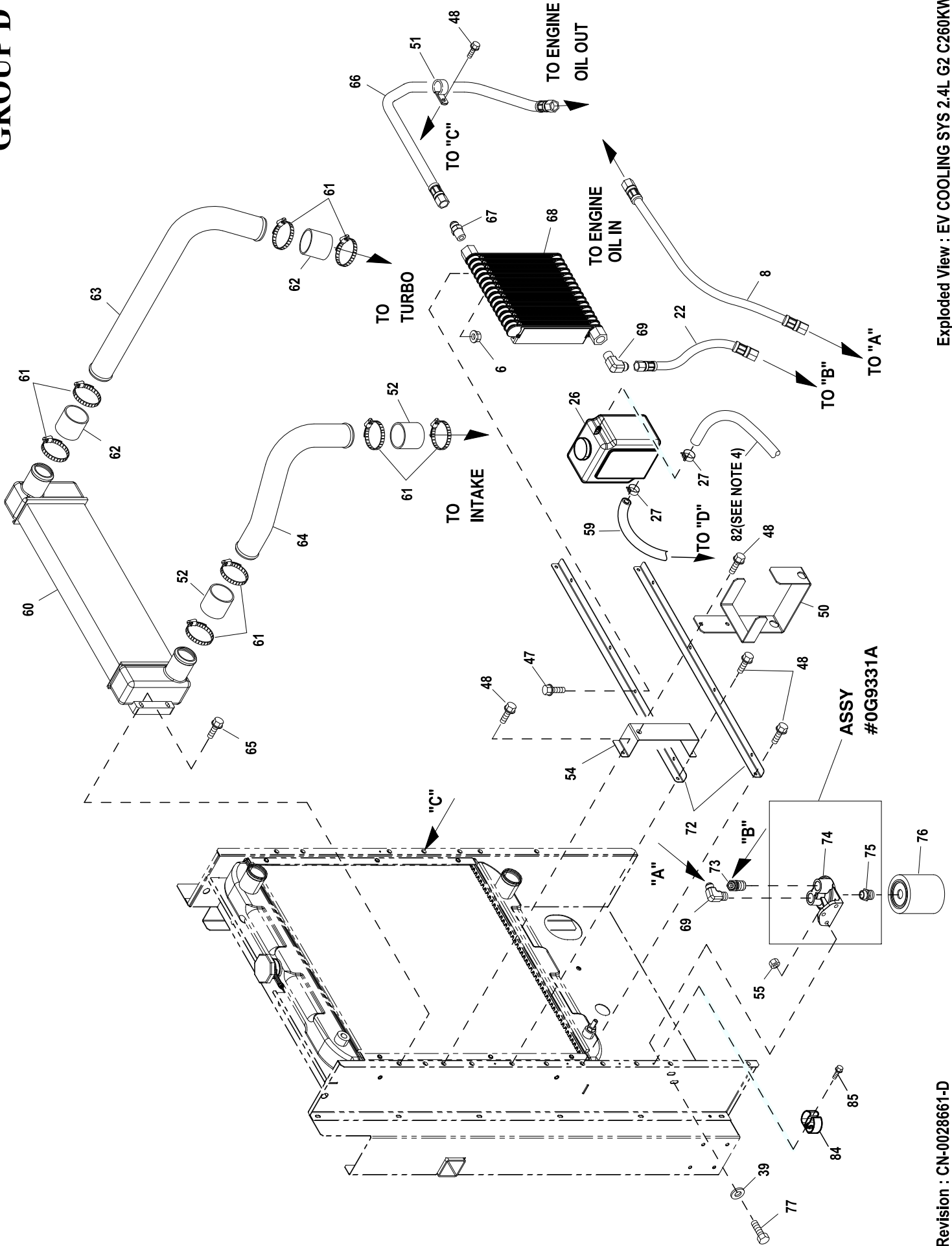

ASSY #0G9331A

EXPLODED VIEW: EV COOLING SYSTEM 2.4L G2 C2 60KW TURBO

DRAWING #: 0L1791

GROUP D

ITEM	PART#	QTY.	DESCRIPTION
1	OH30830ST0R	1	WELDMENT RADIATOR SUPPORT C2
2	10000041323	1	RADIATOR 598 X 568 X 49 CPL RH
3	OF5263	1	V-BELT 31/64" X 57-3/8"
4	046526	5	WASHER LOCK M10
(1)5	G059981	4	SCREW HHC M10-1.5 X 30 G10.9
6	OD3700	4	NUT FLANGE M6-1.0 NYLOK
7	OF5050A	1	SHIELD RADIATOR C4
8	OG9332C	1	OIL LINE REMOTE FILTER/ENGINE
9	OF2573	1	PULLEY FAN V-GROOVE 9"
10	OF4011	1	FAN COOL 22" DIA 10 BLADE LH
11	OH20620ST0R	1	ARM BELT TENSIONER
(1)12	OH2051	1	SHOULDER BOLT 1/2 X 2-1/4"
13	OF2862	1	SPRING TENSION CPL
14	OF2560	1	PULLEY V-BELT 4" FLANGED
15	G022131	4	WASHER FLAT 3/8-M10 ZINC
16	OH1827	1	PROBE COOLANT LEVEL 3/8-18NPTF
17	G035685	2	CLAMP HOSE #28 1.32-2.25
18	OF2561	1	HUB FLEX PLATE
19	OC8145	8	WASHER FLEX (THIN)
20	G052250	2	TAPE FOAM 1 X 1 (26.75" LG)
21	OC7043	12	DISK FLEX
22	OG9332B	1	OIL LINE REMOTE COOLER/FILTER
23	G022473	8	WASHER FLAT 1/4-M6 ZINC
(1)24	OC8146	4	SCREW HHC 5/16-24 X 1.124
25	G022097	16	WASHER LOCK M6-1/4
26	G076749	1	TANK COOLANT RECOVERY
27	048031C	3	CLAMP HOSE BAND .50
28	G031971	1	BEARING #6205 2NSE C3 E SRI2 S
29	OH0271	1	PULLEY 5.125" DIA MACHINED
(1)30	G042911	1	SCREW HHC M10-1.5 X 30 G8.8
(1)31	OF2872	1	SCREW HHC 1/2-13 X 2" G8
32	G022304	1	WASHER FLAT 1/2 ZINC
33	G022195	1	WASHER LOCK 1/2
34	G022196	1	NUT HEX 1/2-13 STEEL
35	OF8651	8	SCREW HHFC M8-1.25 X 20 W/M6
36	G052677	1	WASHER NYLON .50 X .87 X .06
37	OF9867	1	SHAFT FAN DRIVE
38	OF2461	1	RETAINER BEARING
39	G022145	8	WASHER FLAT 5/16-M8 ZINC
40	G022129	9	WASHER LOCK M8-5/16
(1)41	G039287	1	SCREW HHC M8-1.25 X 45 C8.8
42	G082774	1	KEY WOODRUFF 4 X 19D
43	OG0795	1	HOSE LOWER RADIATOR G2
44	OH1546	1	HOSE UPPER RADIATOR G2
45	G049813	8	NUT HEX M6 X 1.0 G8 YEL CHR
46	G052644	1	SPACER .5 X 1.5 X .25 STL/ZINC
47	OC8566	20	SCREW HHFC M6-1.0 X 20 G8.8
48	OC2454	9	SCREW THF M6-1 X 16 N WA Z/JS
49	G090283	1	CAP RADIATOR 13 PSI
50	G080713	1	BRACKET COOLANT TANK
51	055934M	1	CLAMP STL/VNL .75 X .343 Z
52	0A5259A	2	HOSE 2"ID X 3.0"LG
53	G039253	2	SCREW HHC M8-1.25 X 20 C8.8
54	OG9595	1	BRACKET RESERVOIR MOUNTING
55	G049820	5	NUT HEX LOCK M8-1.25 NY INS
56	OH30880ST0R	1	BRACKET TENSIONER SPRING
57	G099502	2	CLAMP HOSE #24 B1.06-2.00
58	OC8165	2	NUT HEX LOCK 5/16-24 NY INS
59	G029032	1	HOSE 9/32 ID (32"LG)
60	OG3762	1	CAC 504W X 152H X 50D 2.4L G2
61	OG1285C	8	CLAMP CNST TENSION 1.75-2.625
62	071296A	2	HOSE 2"ID X 3.0"LG
63	OG3985	1	TUBE CAC IN G2 TURBO
64	OG3989	1	TUBE CAC OUT G2 TURBO
65	OC2454B	4	SCREW THF M6-1 X 30 N WA DELTA

EXPLODED VIEW: EV COOLING SYSTEM 2.4L G2 C2 60KW TURBO**DRAWING #: 0L1791****GROUP D**

ITEM	PART#	QTY.	DESCRIPTION
66	0G9332A	1	OIL LINE REMOTE ENG/COOLER
67	0C4975	1	ADAPTOR 1/2 NPT X 3/4 JIC 3/4-16
68	0G3990	1	COOLER OIL 2.4L G2 TURBO
69	0C4973D	2	ADAPTER 90D JIC37 1/2NPT X 3/4
(3)70	0H2844	2 (REF)	BEARING SLEEVE 1/2" X 3/4 X 1
71	0G53150AL0R	1	SPACER CPL COOLING FAN 1/8"
72	0G3986	2	MOUNT OIL COOLER 2.4L G2
73	0G9910	1	ADAPTER 45D JIC37 1/2NPT X 3/4
74	0G9331	1	MOUNT REMOTE OIL FILTER 2.4 G2
(2)75	0G9333	1	NIPPLE-OIL FILTER
76	0A45310244	1	FILTER 1.5L/2.4L G2 OIL
77	G043107	3	SCREW HHC M8-1.25 X 25 C8.8
78	048031J	1	CLAMP HOSE BAND .63
79	029333A	9	TIE WRAP UL 7.4" X .19" BLK (NOT SHOWN)
80	0D3700	8	NUT FLANGE M6-1.0 NYLOK
81	069860C	1	HOSE OIL DRAIN ASSY 21"
82	G029032	1	HOSE 9/32 ID (27"LG)
83	G085662	3	TIE WRAP UL 14.6 X .14 BLK (NOT SHOWN)
84	G065852	1	SPRING CLIP HOLDER .37-.62
85	G045764	1	SCREW HHTT M4-0.7 X 8 ZP
86	G026850	8	WASHER LOCK EXT 1/4 STL
87	G058653	8	WASHER FLAT M8

BEARING PRESS NOTE:

APPLY LOCTITE 620 BEARING RETAINMENT COMPOUND TO BEARING SURFACE ON ITEM 37 PRIOR TO PRESSING ITEM 28 ONTO ITEM 37.

ALSO APPLY LOCTITE 620 BEARING RETAINMENT COMPOUND TO THE OUTSIDE OF 28 PRIOR TO INSTALLING ITEM 28 INTO ITEM 38.

- (1) APPLY MEDIUM STRENGTH BLUE THREAD LOCKING FLUID TO THREADS.
- (2) APPLY LOCTITE #266 TO I/N 75 PRIOR TO ASSEMBLY.
- (3) ITEM 70 IS INCLUDED WITH ITEM 1.
- (4) FASTEN HOSE TO RADIATOR SUPPORT USING TIE WRAP I/N 83. DIRECT HOSE TOWARD BASE OF UNIT.
- (5) ALL STANDARD HARDWARE TO BE TORQUED PER EDS001.
- (6) TORQUE VALUES: (FOR REFERENCE ONLY)
 - ITEM # 5 – 35 ft-lbs.
 - ITEM # 24 – 18 ft-lbs.
 - ITEM # 30 – 35 ft-lbs.
 - ITEM # 31 – 78 ft-lbs.
 - ITEM # 41 – 18 ft-lbs.
 - ITEM # 47 – 8 ft-lbs.