

GROUP E

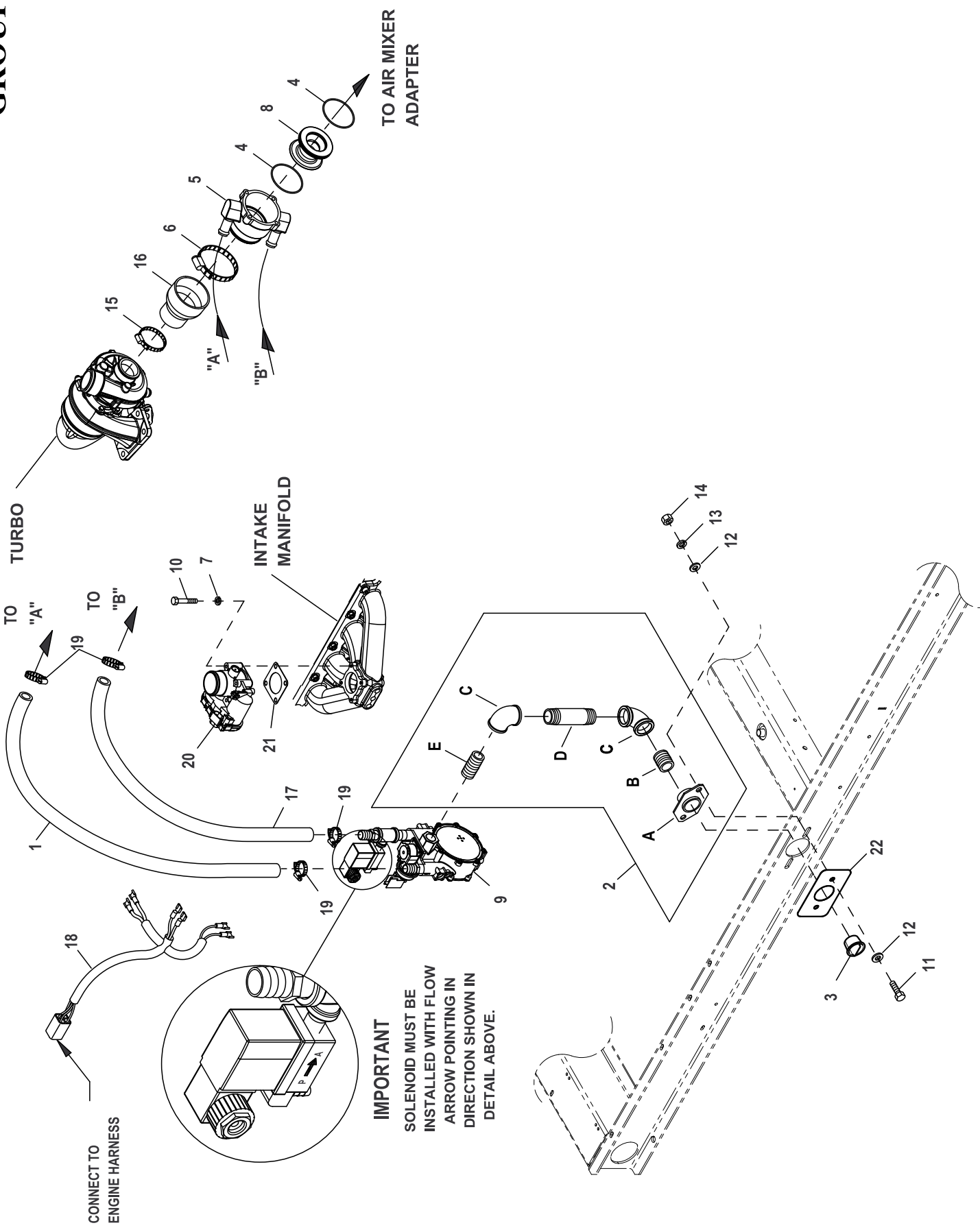

IMPORTANT
 SOLENOID MUST BE
 INSTALLED WITH FLOW
 ARROW POINTING IN
 DIRECTION SHOWN IN
 DETAIL ABOVE.

EXPLODED VIEW: EV FUEL SYSTEM LP 2.4L 60KW**DRAWING #: 0K9082A****GROUP E**

ITEM	PART#	QTY.	DESCRIPTION
1	059057	1	HOSE 3/4 ID SAE-30R2 (45"LG)
2	0F8274	1	ASSY RGLTR INLET NPT FITTINGS
A	075580	1	FLANGE, FUEL INLET
B	026915	1	NIPPLE CLOSE 3/4 X 1.375
C	026812	2	ELBOW 90D 3/4NPT
D	0F8379	1	NIPPLE PIPE 3/4 NPT X 7
E	026915	1	NIPPLE CLOSE 3/4 X 1.375
3	0D8741	1	PLUG PLASTIC 3/4 NPT CNTR PULL
4	0G3167	2	O-RING 2-3/4 X 3/32 X 2-15/16
5	0F3885	1	MIXER 40/60MM ACTUATOR ASSY
6	086133E	1	CLAMP HI TORQUE 2.75 - 3.625
7	022097	4	WASHER LOCK M6-1/4
8	0F3691	1	VENTURI THROTTLE 32MM
9	0G9189C	1	REG ASSY 2.4L 60KW LPV CPL
10	046580	4	SCREW SHC M6-1.0 X 45 C12.9
11	043107	2	SCREW HHC M8-1.25 X 25 C8.8
12	022131	4	WASHER FLAT 3/8-M10 ZINC
13	022129	2	WASHER LOCK M8-5/16
14	045771	2	NUT HEX M8-1.25 G8 CLEAR ZINC
15	086133C	1	CLAMP HI TORQUE 1.75 - 2.625
16	0F3857	1	REDUCER RUBBER 3.0"-2.00"
17	059057	1	HOSE 3/4 ID SAE-30R2 (41" LG)
18	0F6155	1	HARNES FUEL JUMPER SINGLE REG
19	057823	4	CLAMP HOSE #10 .56-1.06
20	0E4394	1	ACTUATOR BOSCH 40 GOVERNOR
21	0E6586	1	GASKET BOSCH 32
(1)22	0K83280ST0R	1	BASE FRAME BLOCK OFF PLATE

NOTES (UNLESS OTHERWISE SPECIFIED):

(1) SHEET METAL PARTS LISTED IN THE BOM TABLE ARE REPRESENTING GENERIC PARTS (NO COLOR)

- MANUFACTURING: FOR CORRECT MATERIAL AND COLOR REFER TO XA BOM.
- CUSTOMER: WHEN ORDERING REPLACEMENT PARTS ENTER BASE NUMBER (FIRST 6 DIGITS ONLY) IN THE SYSTEM FOR CORRECT MATERIAL AND COLOR (FOR REFERENCE SEE GUIDELINE 0H7169).