

REV	DATE	BY	CHKD	DESCRIPTION
1				DESCRIPTION
1				YFRSW HSB 200A 2P 250V
2				SCREW HHTT M5-0.8 X 10 BP
3				LUG SLDLSS 250-#6 AL/CU
4				SCREW BHSC 1/4-20 X 3/8
5				WASHER LOCK M6-1/4
6				SCREW HHTT M4-0.7 X 10 BP
7				RELAY PNL 12VDC DPTD 10A@240VA
8				FUSEBLOCK 30A 600V 3POS W/SO
9				FUSE 5A X BUSS
10				TERM BLOCK 3P UL 12-20AWG
11				SCREW THTT M3-0.5 X 25 ZP
12				ASSY-NEUT BLK 200A W/TAP
13				SCREW HHTT M6-1.0 X 12 ZINC
14				ENCLOSURE 100/200A XFER SW-RAW
15				COVER 100A XFER SWITCH-INST-RAW
16				SUBPLATE, 100/200A XFER SW
17				SCREW HHTT #8-32 X 1/4 CZ
18				DECAL DATA NON SE SW 200A
19				DECAL MANUAL 5A FUSE
20				DECAL, NEUTRAL
21				90 DEGREE DN SPADE CONNECTOR
22				DECAL TEST SEQUENCE 100/200A NON
23				DECAL LIVE CIRCUIT ENG/FRN/SPN
24				DECAL UTILITY LOAD SENSE 240V
25				LUG SLDLSS 270-#14X#10-32X.125
26				WASHER LOCK EXT 1/4 STL
27				WASHER FLAT 1/4-M6 ZINC
28				WASHER NYLON .257
29				SCREW HHC 1/4-20 X 1/2 SS
30				RIVET POP .156 X .362 AL
31				PIN ARM EXTENDER
32				BRACKET, ARM EXTENDER
33				SCREW HHTT M3-0.5 X 6 BP
34				NUT HEX FL WH1Z 1/4-20
35				DECAL RTS TRANSFER SW GENERAC
36				DECAL NEC COMPLIANCE
37				DECAL CUSTOMER CONN RTS
38				CHANNEL SNAPTRACK 76.2 X 101.2
39				ASSY SMART AC MOD
40				NUT TRIC 1/4-20 ALUM
41				WIRE HARNESS 100/200A RTS

\*SERIAL NUMBER AND FRONT DECAL PER MODEL  
 \*\*SUPPLIED WITH HARNESS ITEM #41

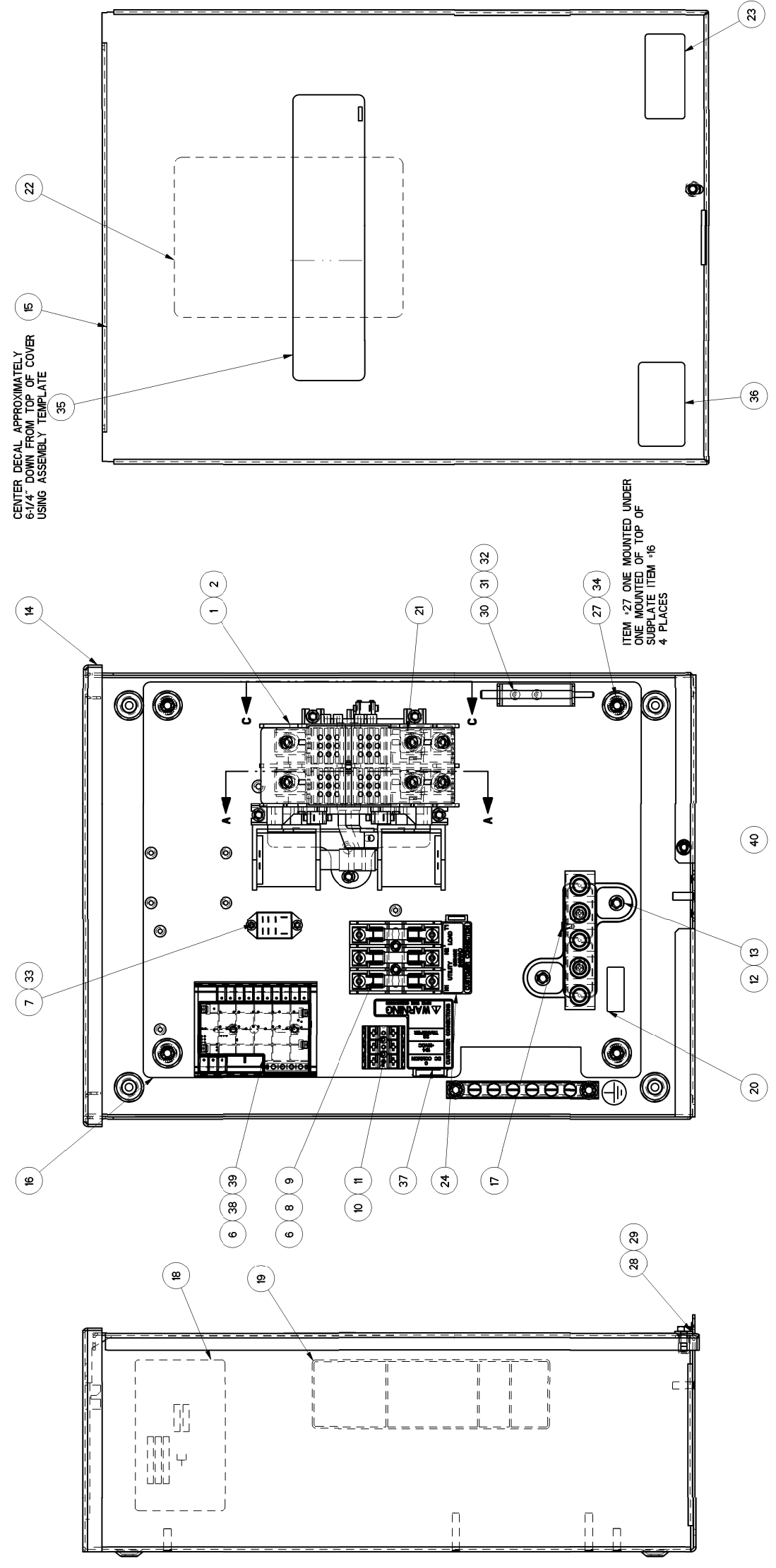

CENTER DECAL APPROXIMATELY  
 5/16" DOWN FROM TOP OF COVER  
 USING ASSEMBLY TEMPLATE

ITEM #27 ONE MOUNTED UNDER  
 ONE MOUNTED ON TOP OF  
 SUBPLATE ITEM #16  
 4 PLACES

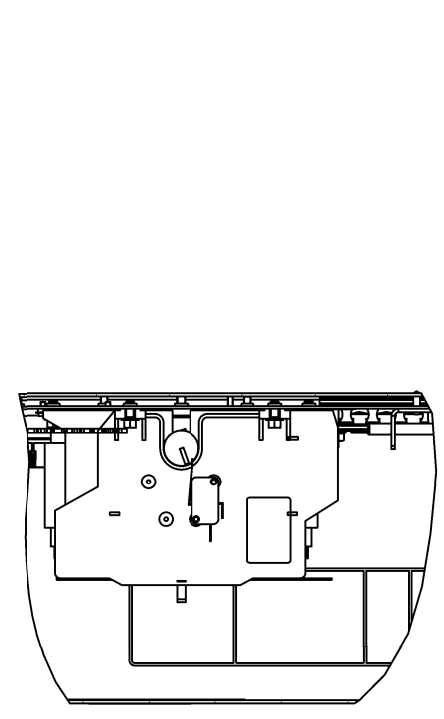

SECTION C-C

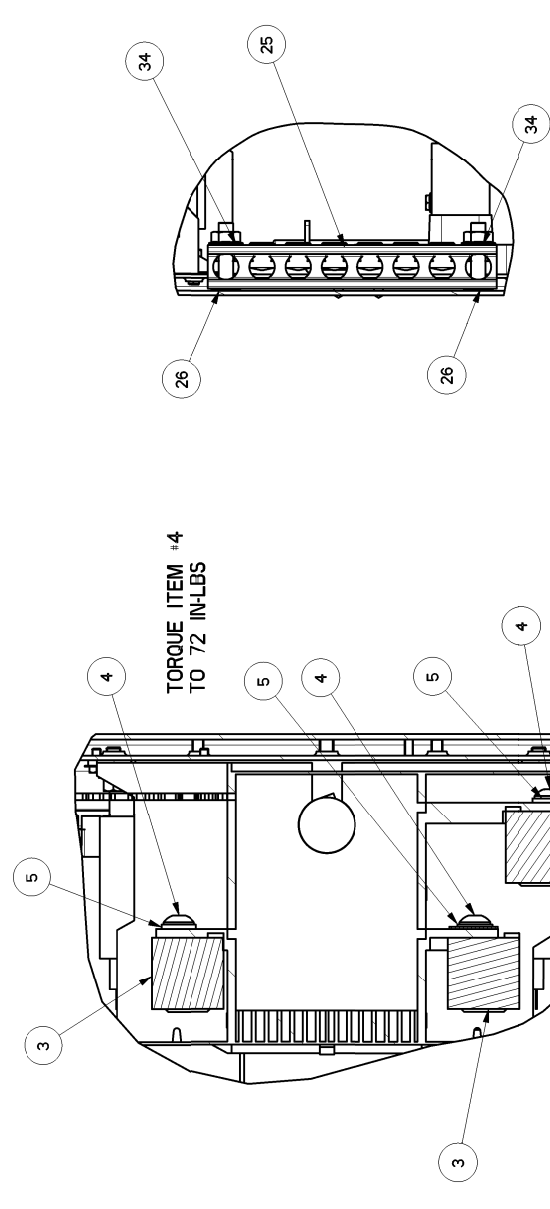

TORQUE ITEM #4  
 TO 72 IN-LBS

SECTION B-B  
 SCALE 0.600

SECTION A-A  
 SCALE 0.750

PART NUMBER	DESCRIPTION	ITEM # 18	ITEM # 35
OL321I	ASSEMBLY 200A 120/240 NON SE	0K799B	PER MODEL
OL321IA	EXPLODED VIEW DRAWING	N/A	N/A
OL321IB	ASSEMBLY 200A 120/240 NON SE	0K799B	0K099B
OL321IC	ASSEMBLY 200A 120/240 NON SE	0J3806B	0K1274

REFERENCE DRAWINGS  
 OL3241 SCHEMATIC/WIRING DIAGRAMS  
 OF6778 CARTON 30.5 X 14.2 X 7.8  
 OH7275 TEST PROC HSB YFRSW  
 OK015 KIT ENCL 100/200A NON SE AL

DRAWING CREATED FROM PRO/ENGINEER  
 3D FILE. NO MODIFICATION TO BE  
 APPLIED TO SOLID MODEL ONLY.

GENERAL TOLERANCES UNLESS NOTED  
 ALL DIMS ± 0.4 MM  
 ALL ANGLES ± 0.5°  
 INTERPRET DIM AND TOL  
 PER ASME Y14.5M-1994

THIRD ANGLE PROJECTION

ISSUE DATE: \_\_\_\_\_  
 SCALE: 0.450 WT-NG: 22428213.136 SHEET 1 of 1

**GENERAC**

ASSEMBLY DWG 2-POLE  
 200A 120/240V

REV C  
 DWG NO 0L321I\$  
 CAGE NO N/A  
 ISSUE DATE: \_\_\_\_\_  
 SCALE: 0.450 WT-NG: 22428213.136 SHEET 1 of 1

GENERAL ASSEMBLY DRAWING