

GROUP F

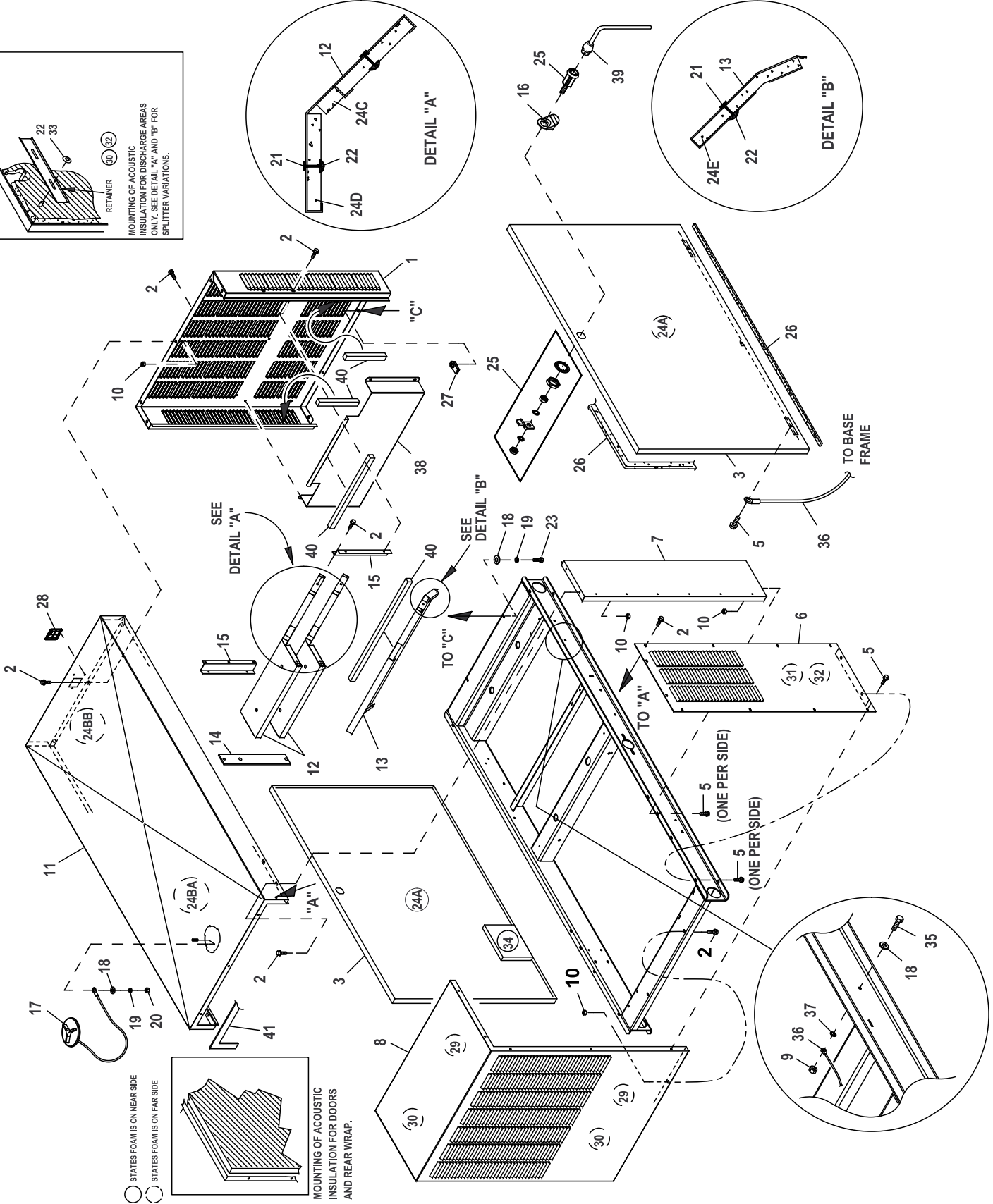
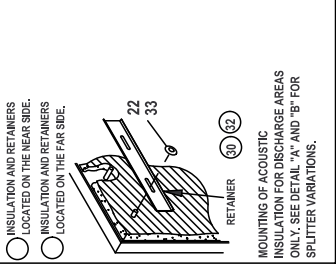

EXPLODED VIEW: EV ENCLOSURE C2 2.4L G2 TURBO

DRAWING #: 0J8688

GROUP F

ITEM	PART#	QTY.	DESCRIPTION
(2)1	0G80180AL0R	1	REAR WRAP C2 G2 60KW
(1)2	0C2454	48	SCREW THF M6-1 X 16 N WA Z/JS
(2)3	0F58490AL0R	2	DOOR C2
4	087233	2	RIVET POP .1875 X .450 SS
(1)5	0E3257	10	SCREW TH-FRM M6 W/CAP SHKPRF W
(2)6	0F58520AL0R	2	DUCT DSCHRG LH&RH
(2)7	0F98330AL0R	2	FRONT CORNERS C2
(2)8	0F58510AL0R	1	DUCT DISCHARGE C2
9	049813	2	NUT HEX M6 X 1.0 G8 YEL CHR
(1)10	077992	17	NUT HEX LOCK M6-1.0 SS NY INS
(2)11	0F98350AL0R	1	ROOF C2
12	0F2786	2	SPLITTER C4
13	0F2785	1	SPLITTER LOWER C4
14	0F3364	1	SPLITTER STINGER C2
15	0F4880	2	SUPPORT SPLITTER LH C2
16	0F5049B	2	PULL TAB DOOR LOCK SS
17	0F4487A	1	ASSEMBLY COVER ACCESS
18	022473	7	WASHER FLAT 1/4-M6 ZINC
19	022097	5	WASHER LOCK M6-1/4
20	022127	1	NUT HEX 1/4-20 STEEL
21	0F3072	10	INSULATION RETAINMENT HANGER
22	078115	26	WASHER SELF LOCKING DOME #4-40
23	0C8566	4	SCREW HHFC M6-1.0 X 20 G8.8
24	0G6001A	1	KIT INSULATION C2
24A	0G5892	2	INSULATION DOOR C2
24B	0L3103	1	KIT INSULATION C2
24BA	0G5892A	1	INSULATION ROOF TOP
24BB	0G5892F	1	INSULATION ROOF TOP
24C	0G5892C	2	INSULATION SPLITTER
24D	0G5892D	2	INSULATION SPLITTER
24E	0G5892E	1	INSULATION LOWER SPLITTER
25	0F5048D	2	WISE-ACTION LATCH SLOTTED CIR
26	0E5968	1	GASKET EXTRUDED TRIM (328" LG)
27	0H0412	4	NUT U M6-1.0 GEOMET
28	0H1208A	1	RF COVER PLATE-PLASTIC-BISQUE
	0H1208B	1	RF COVER PLATE-PLASTIC-GREY
29	0F4051C	2	INSULATION DUCT
30	0F3890B	4	RETAINER INSULATION (820)
31	0F4051B	2	INSULATION DUCT SIDES
32	0F3890	4	RETAINER INSULATION (450)
33	078115A	6	WASHER SELF LOCKING DOME #8-32
34	0E5298L	1	FOAM 300 X 300 THERMAL ACO
35	042568	2	SCREW HHC M6-1.0 X 20 G8.8
36	0912970090	2	ASSY WIRE 14AWG GRN/YEL
37	022447	2	WASHER SHAKEPROOF INT 1/4
38	0G9473	1	DEFLECTOR INTAKE 2.4L G2 TURBO
39	0F8869D	1	KEY WISE-ACTION LATCH SLOT CIR
40	052250	1	TAPE FOAM 1X1 (71.0"LG)
41	066760	1	STRIP SEALANT 1/8 X 1 (44.52"LG)

UNLESS OTHERWISE SPECIFIED:

(1) ENCLOSURE NOTE: PANELS THAT FASTEN TO THE BASEFRAME (EXCEPT ITEM 1) MUST BE SECURED USING I/N 2 & 5 (THREAD FORMING FASTENERS) AND I/N 10 (LOCK NUT). LOCK NUT IS TO BE INSTALLED AFTER THREAD FORMING FASTENER HAS PENETRATED THROUGH EXTRUSIONS IN ENCLOSURE PANELS. ALL PANEL CONNECTIONS TO INCLUDE AT LEAST ONE CONNECTION POINT USING I/N 5 (THREAD FORMING FASTENER).

(2) SHEET METAL PARTS LISTED IN THE BOM TABLE ARE REPRESENTING GENERIC PARTS (NO COLOR)

- MANUFACTURING: FOR CORRECT MATERIAL AND COLOR REFER TO AS400 BOM.
- CUSTOMER: WHEN ORDERING REPLACEMENT PARTS ENTER BASE NUMBER (FIRST 6 DIGITS ONLY) IN THE SYSTEM FOR CORRECT MATERIAL AND COLOR (FOR REFERENCE SEE GUIDELINE 0H7169).