

# GROUP D

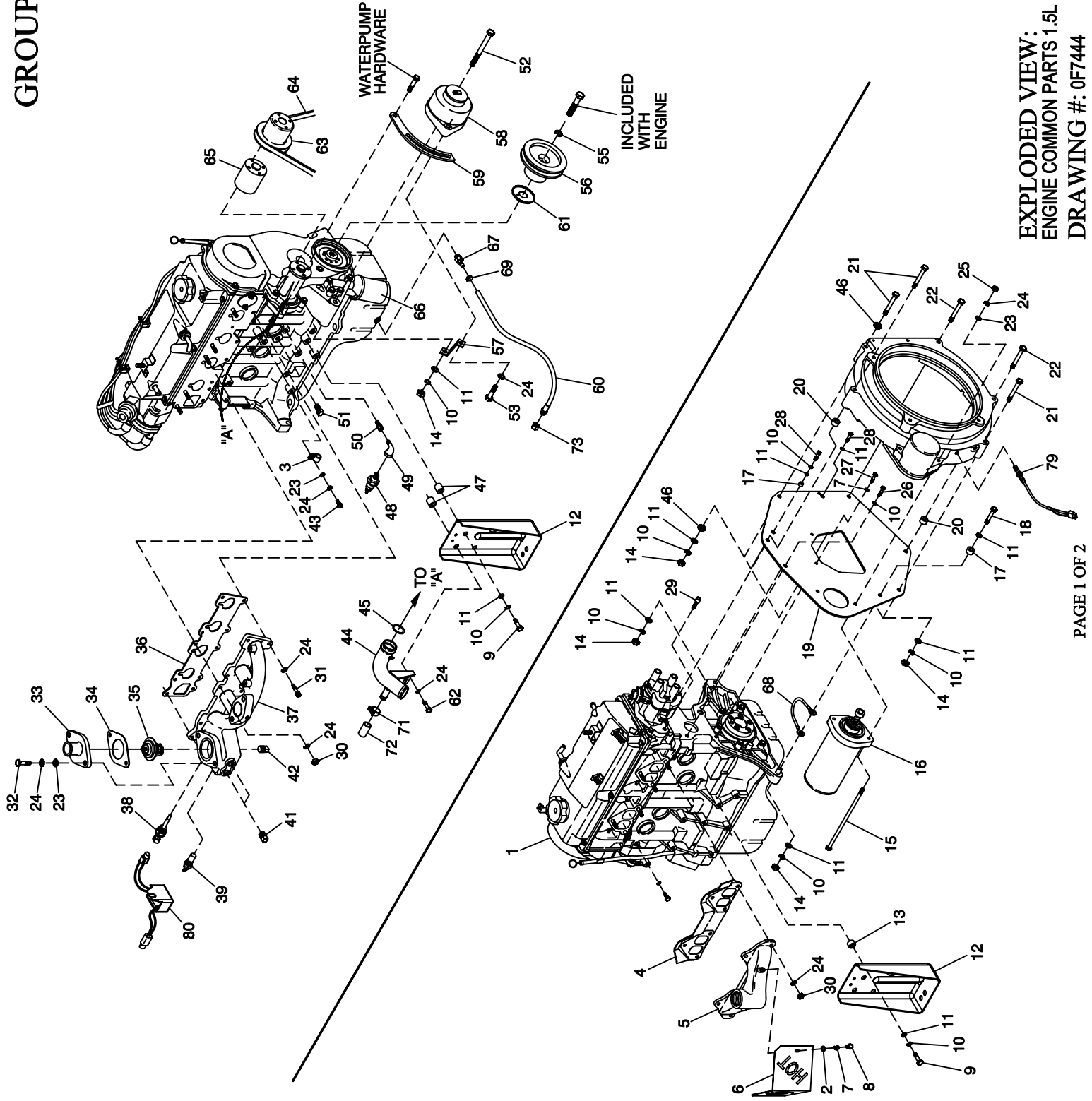

EXPLODED VIEW:  
ENGINE COMMON PARTS 1.5L CPL  
DRAWING #: 0F7444

**EXPLODED VIEW: ENGINE COMMON PARTS 1.5L CPL  
DRAWING #: 0F7444**

**GROUP D**

APPLICABLE TO:

ITEM	PART #	QTY.	DESCRIPTION
1	0A4531	REF.	ENGINE-1.5L
2	022473	2	WASHER FLAT 1/4 ZINC
3*	055934C	1	CLAMP VINYL .5 X .406 Z
4	0A45310258	REF.	GASKET-EXHAUST MANIFOLD
5	0A4355	1	MANIFOLD-EXHAUST
6	0E2632	1	HEAT SHIELD EXH 1.5L
7	022097	4	WASHER LOCK M6-1/4
8	022507	2	SCREW HHC 1/4-20 X 1/2 G5
9	052212	4	SCREW HHC M10-1.25 X 25 G8.8
10	046526	4	WASHER-LOCK-M10
11	022131	20	WASHER FLAT 3/8 ZINC
12	0C2499	2	STAMPING ENG FOOT
13	055993	1	SPACER .41 X .75 X .12 STL/ZNC
14	045772	1	NUT HEX M10-1.5 G8 YEL CHR
15	023586	2	SCREW SHC 5/16-18 X 2 G8.8 NZ
16	020692	1	STARTER-12V
17	0A7005	2	SPACER .56 X 1 X .37 ST/ZNC
18	052243	1	SCREW HHC M10-1.5 X 60 G8.8
19	0A4772	1	ENGINE PLATE
20	070901	2	SLEEVE DOWEL BLHSG
21	051735	3	SCREW HHC M10-1.5 X 70 G8.8
22	056768	3	SCREW HHC M10-1.5 X 90 G8.8
23	022145	12	WASHER FLAT 5/16 ZINC
24	022129	19	WASHER LOCK M8-5/16
25	022259	2	NUT HEX 5/16-18 STEEL
26	052213	11	SCREW HHC M10-1.25 X 20 G8.8
27	047411	2	SCREW HHC M6-1.0 X 16 G8.8
28	052830	1	SCREW HHC M10-1.25 X 45 G8.8
29	0C3153	1	SCREW TBH M8-1.25 X 30
30	045771	12	NUT HEX M8-1.25 G8 YEL CHR
31	058306	5	SCREW SHC M8-1.25 X 25 G12.9
32	030795	2	SCREW HHC 5/16-18 X 1 G5
33	0A2711A	1	ADAPTER-THERMOSTAT
34	048665	1	GASKET THERMOSTAT
35	075885	1	THERMOSTAT 195 DEG
36	0A45310257	REF.	GASKET INLET MANIFOLD
37	0E1100	1	MANIFOLD INTAKE MACHINED
38	0E2507	1	PROBE, COOLANT LEVEL 3/8NPTF
39	0A6751	1	SW-TMP 245 DEG 3/8 NPT
41	026925	2	PLUG STD PIPE 3/8 STEEL SQ HD
42	061012	1	PLUG STD PIPE 1/8 SCKT HD
43	039253	5	SCREW HHC M8-1.25 X 20 G8.8
44	0A5110	1	PIPE WATER-INLET
45	0A7006	1	O-RING 1-1/16 X 1-5/16 X 1/8
46	025507	2	WASHER SHAKEPROOF EXT 7/16 STL
47	022500B	2	SPACER .41 X .75 X .25 ST/ZNC
48	0A8584	1	SWITCH OIL PRESSURE
49	036277	1	ELBOW 90D STREET 1/8
50	042574	1	ADAPTOR 1/8 NPTF TO 1/8-28
51	026073A	1	PLUG STD PIPE 1/4 STEEL SQ HD
52	0A6701	1	SCREW HHC M10-1.5 X 110 G8.8
53	039414	1	SCREW HHC M8-1.25 X 35 G8.8
55	051769	1	WASHER LOCK M12
56	0A4800A	1	PULLEY-CRANKSHAFT (3600 RPM)
57	0A5839	1	BRACKET - ALT SUPPRT
58	0A1354B	1	DC ALTERNATOR-12V
59	0A4839	1	ARM ADJUST ALTERNATOR
60	069860C	1	HOSE ASM.-OIL DRAIN
61	0F3856	1	GUARD CRANKSHAFT 1.5L
62	058443	2	SCREW CRIMPTITE 1/4-20 X 5/8
63	0A2628	1	PULLEY - FAN 95 DIA
64	0A5586	1	V-BELT 3/8 X 28.9D
65	0A4814	1	SPACER PULLEY
66	0A45310244	REF.	FILTER OIL
67	0C1852	1	ADAPTER DRAIN OIL
68	0912970066	1	GROUND WIRE (STARTER)
69	070928	1	CLAMP HOSE - OIL DRAIN
70	069860C	1	HOSE OIL DRAIN ASSY 21"

ITEM	PART #	QTY.	DESCRIPTION
71	035473	1	CLAMP HOSE #12 .50-1.25
72	077996	1	CAP ANTIFREEZE RUBBER
73	069811	1	CAP HEX 1/4 NPT BRASS
74**	0A1354A	1	REGULATOR - DC ALT
75**	0E3257	2	SCREW HWHTF M6-1.0 X 16
76**	022473	2	WASHER FLAT 1/4-M6 ZINC
77**	022097	2	WASHER LOCK M6-1/4
79	0D2244M	1	ASSY MAGPICKUP (3/8-24 MALE)
80	0F9483	1	ASSY PCB WATERLEVEL SNSR INTFC

\* CLAMP FOR WIRING HARNESS (NOT SHOWN)

\*\* NOT SHOWN