

# GROUP A

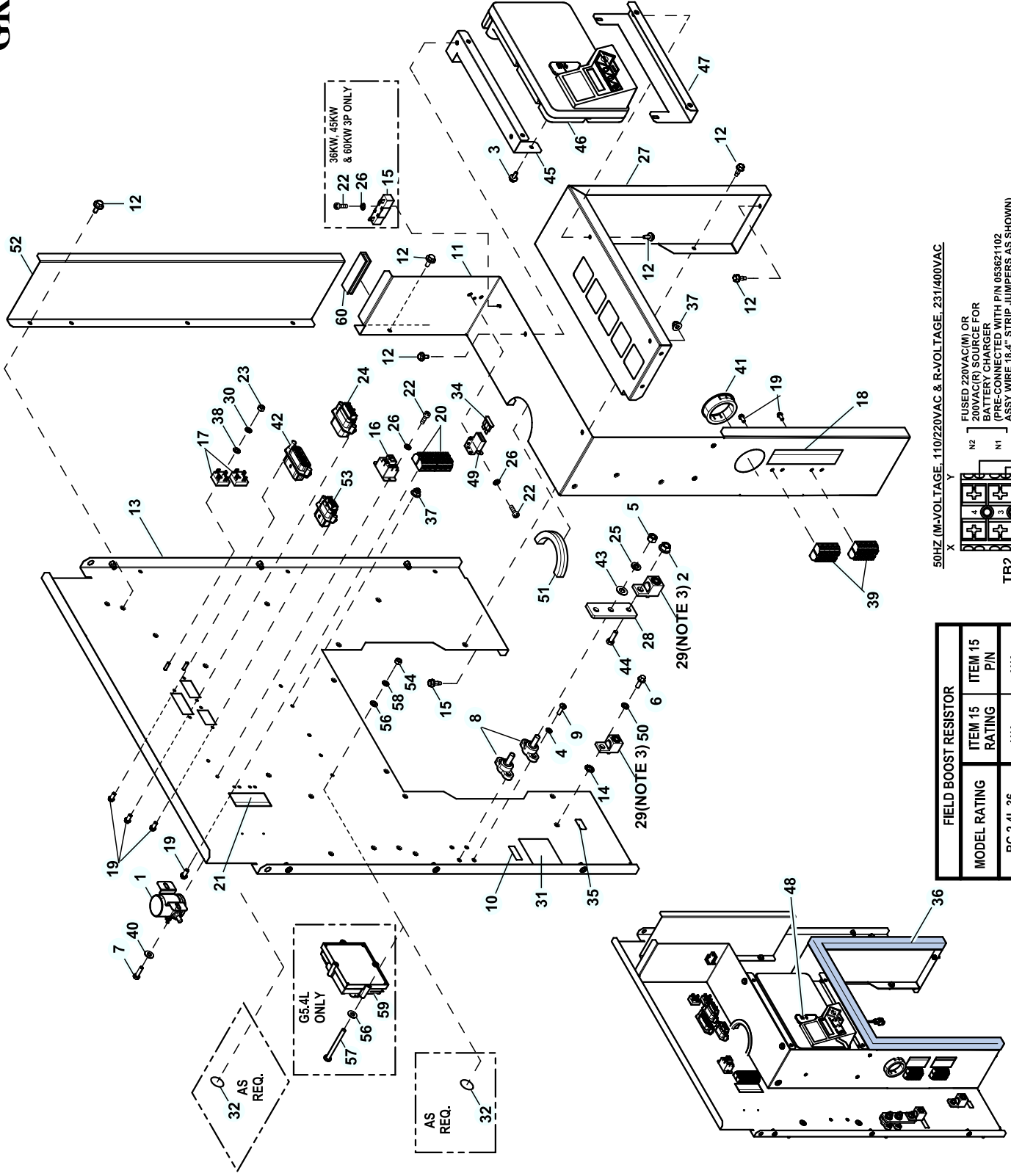

50HZ (M-VOLTAGE, 110/220VAC & R-VOLTAGE, 231/400VAC)

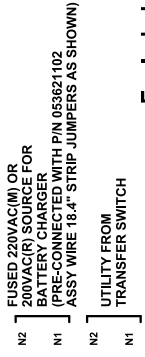

FUSED 220VAC(M) OR 200VAC(R) SOURCE FOR BATTERY CHARGER (PRE-CONNECTED WITH PIN 055621102 ASSY WIRE 16.4" STRIP JUMPERS AS SHOWN) UTILITY FROM TRANSFER SWITCH

FIELD BOOST RESISTOR	ITEM 15 RATING	ITEM 15 P/N
RG 2.4L 36, 45 & 60 KW - 1Ø	N/A	N/A
RG 2.4L 36, 45 & 60 KW - 3Ø	10 OHM	0F5752J

## EXPLODED VIEW: EV CONNECTION BOX C2 CPL

DRAWING #: 10000031071

## GROUP A

ITEM	PART#	QTY.	DESCRIPTION
1	G056739	1	RELAY SOLENOID 12VDC PNL MNT
2	G067989	1	NUT HEX FL WHIZ M8-1.25
3	G090388	4	SCREW HHTT M6-1.0 X 12 ZINC
4	G022264	4	WASHER LOCK #8-M4
5	G022241	2	NUT HEX 3/8-16 STEEL
6	OG3111	1	SCREW HHTT M6-1.0 X 25 ZINC
7	G042568	2	SCREW HHC M6-1.0 X 20 C8.8
8	G057073	2	JUNCTION BLOCK 3/8-16
9	OC2265	4	SCREW PHTT M4-0.7 X 12 ZP
10	OA9457	1	DECAL, NEUTRAL
11	OK2938	1	CONNECTION BOX LH SIDE C2 CPL
12	OE3257	24	SCREW HWHTF M6-1.0 X 16
13	OK8625	1	CONNECTION BOX CENTER C2 CPL
14	OA1658	1	WASHER LOCK SPECIAL 1/4"
15	OF5752J	1	RES WW 10R 5% 25W QK CONN (SEE TABLE)
16	OK2098	1	RELAY 12V 30A SPST PILOT DUTY
17	OD7177V	2	DIODE BRIDGE 1P 35A 1000V
18	A0000116161	1	DECAL TB2/TB3 CUSTOMER POWER CONN 50HZ
	A0000116162	1	DECAL TB2/TB3 CUSTOMER POWER CONN 60HZ
19	OF5458	14	SCREW HHSP #10 X 3/8 HI-LOW
(1)20	OD7393T	2(REF)	TERM BLOCK 3P UL 12-20AWG
21	OH7293	1	DECAL CONBOX TB1 CONNECTIONS
(4)22	OC2428	4 / 5	SCREW PHTT #6-32 X 1/2 ZYC
23	G051716	2	NUT HEX M5-0.8 G8 CLEAR ZINC
(1)24	OF5396S0AR	1(REF)	MX150L SLRRMNT 22-18 12P W/OGA
25	G022237	2	WASHER LOCK 3/8
(4)26	G022155	4 / 5	WASHER LOCK #6
27	OK2937	1	CONNECTION BOX RH SIDE C2 CPL
28	OH9690	1	BUS BAR NTRL BLK 15-250A
(3)29	OF8451	2	LUG SLDLSS 300 MCM-6 AL/CU
30	G049226	2	WASHER LOCK M5
31	OH8006B	1(REF)	DECAL CAUTION ELEC SHOCK SM
(5)32	OF6145	A/R	SEAL WEATHER .63"DIA
33	---	--	-----
(1)34	OE7403C	1(REF)	FUSE ATO TYPE 15 AMP (BLUE)
35	067210A	1	DECAL GROUND LUG (60HZ UNITS)
	OG8785	1	DECAL, GROUNDING ELECTRODE (50HZ UNITS)
36	G052250	1	TAPE FOAM 1X1 (54"LG)
37	OD3700	4	NUT FLANGE M6-1.0 NYLOK
38	G051713	2	WASHER FLAT M5
(1)39	OD7393U	2(REF)	TERM BLOCK 4P UL 12-20AWG
40	G022473	2	WASHER FLAT 1/4-M6 ZINC
41	023484N	1	BUSHING SNAP SB-2.5-31
(1)42	OF540500AR	1(REF)	MX150L RRMNT PLG 16P W/O G A
43	G022131	2	WASHER FLAT 3/8-M10 ZINC
44	G043107	1	SCREW HHC M8-1.25 X 25 C8.8
45	OK3257	1	CONTROLLER TOP STANDOFF
46	OK2267C	1	ASSY CONTROLLER PROTECTOR CPL
47	OK3258	1	CONTROLLER BOTTOM STANDOFF
(2)48	OD7178T	1(REF)	FUSE ATO TYPE 7.5AMP (BROWN) (NOT SHOWN)
(1)49	OF1262	1(REF)	HOLDER FUSE WICKMANN ATO STYLE
	OF1263	1(REF)	ADAPTER RH SIDE WICKMANN
	OF1264	1(REF)	ADAPTER LH SIDE WICKMANN
50	G022097	1	WASHER LOCK M6-1/4
51	G056326	1	TRIM VINYL BLACK 1/8GP (6"LG)
52	OK5555B	1	DEFLECTOR AIR INTAKE C2
(1)53	OF5386S0AR	1(REF)	MX150L SLRRMNT 22-18 10P W/OGA
54	G022158	2	NUT HEX #10-32 STEEL
55	10000024359	1	HARN CONBOX G2.4L/G5.4L PROTECTOR W/ES (NOT SHOWN)
56	G023897	4	WASHER FLAT #10 ZINC
57	G036943	2	SCREW PPHM #10-32 X 2

**EXPLODED VIEW: EV CONNECTION BOX C2 CPL**

**DRAWING #: 10000031071**

**GROUP A**

<b>ITEM</b>	<b>PART#</b>	<b>QTY.</b>	<b>DESCRIPTION</b>
58	G022152	2	WASHER LOCK #10
59	0H6169C	1	ASSY PROG 2010 IGN MOD 8 CYL
60	G056326	1	TRIM VINYL BLACK 1/8GP (5"LG)

NOTES (UNLESS OTHERWISE SPECIFIED):

- (1) ITEMS INCLUDED WITH HARNESS.
- (2) ITEMS INCLUDED WITH CONTROLLER P/N 0K2267C.
- (3) TORQUE VALUES:  
1/IN 29 (SET SCREW) TO 31 ft-lbs.
- (4) QTY. REQ. FOR 36, 45, & 60 KW 1P / QTY. REQ. FOR 36, 45 & 60 KW 3P
- (5) USED TO SEAL UNUSED HOLES.

**EXPLODED VIEW: EV CONNECTION BOX C2 CPL**

**DRAWING #: 1000031071**

**GROUP A**

---

<b>ITEM</b>	<b>PART#</b>	<b>QTY.</b>	<b>DESCRIPTION</b>
-------------	--------------	-------------	--------------------

---

This page left blank intentionally