

GROUP F

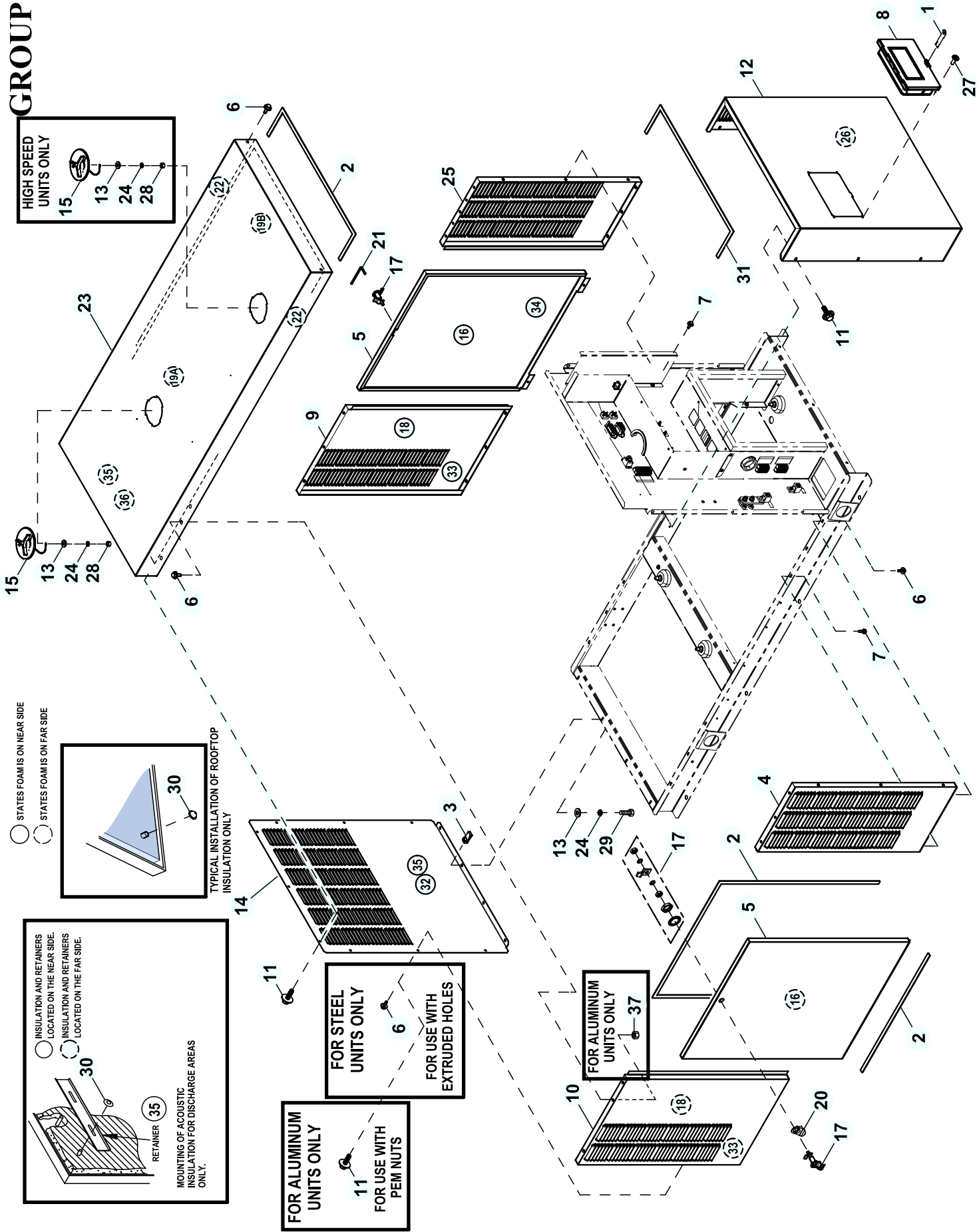

○ STATES FOAM IS ON NEAR SIDE
 ○ STATES FOAM IS ON FAR SIDE

○ INSULATION AND RETAINERS LOCATED ON THE NEAR SIDE.
 ○ INSULATION AND RETAINERS LOCATED ON THE FAR SIDE.

RETAINER (35)

MOUNTING OF ACOUSTIC INSULATION FOR DISCHARGE AREAS ONLY.

FOR ALUMINUM UNITS ONLY
 11 FOR USE WITH PEM NUTS

FOR STEEL UNITS ONLY
 6 FOR USE WITH EXTRUDED HOLES

FOR ALUMINUM UNITS ONLY
 37

TYPICAL INSTALLATION OF ROOFTOP INSULATION ONLY

EXPLODED VIEW: EV ENCLOSURE C2 CPL

DRAWING #: 0K6522

GROUP F

ITEM	PART#	QTY.	DESCRIPTION
1	0K4322	1	EYE HASP CUST ACCESS BOX
2	0E5968	1	GASKET, EXTRUDED TRIM (306.0"LG)
3	0H0412	4	NUT U M6-1.0 GEOMET
(1)4	0K37850ST0R	1	REAR LEFT C2 CPL
(1)5	0K37880ST0R	2	DOOR C2 STEEL RAW
(2)(3)6	0C2454	23 / 18	SCREW HWHT M6-1 X 16 N WA Z/JS
(2)7	0E3257	15	SCREW HWHTF M6-1.0 X 16
8	0K3386	1	CUSTOMER ACCESS ASSEMBLY
(1)9	0K40090ST0R	1	FRONT RIGHT CORNER C2
(1)10	0K40100ST0R	1	FRONT LEFT CORNER C2
(3)11	0K8641	9 / 14	SCREW HHFC M6-1.0 X 20 NYL WA
(1)12	0K37870AL0R	1	PANEL CENTER REAR C2 CPL_
(5)13	022473	5 / 6	WASHER FLAT 1/4-M6 ZINC
(1)14	0K65230AL0R	1	FRONT COVER ENCLOSURE C2
(5)15	0F4487	1 / 2	ACCESS COVER
16	0K2671	2	INSUL DOOR C2 D3.4L
17	0F5048D	2	WISE-ACTION LATCH, SLOTTED CIR
18	0K2671B	2	INSUL CORNER POST C2 D3.4L
19	0L3103	1	KIT INSULATION C2
19A	0G5892A	1	INSULATION ROOF TOP
19B	0G5892F	1	INSULATION ROOF TOP
20	0F5049B	2	PULL TAB DOOR LOCK ST
21	0F8869D	1	KEY VISE-ACTION LATCH SLOT CIR
22	0K2671E	2	INSUL ROOF SIDES C2 CPL
(1)23	0K6524AAL0R	1	ROOF C2 AL HIGH SPEED
	0K65240AL0R	1	ROOF C2 AL
(5)24	022097	5 / 6	WASHER LOCK M6-1/4
(1)25	0K37830ST0R	1	REAR RIGHT C2 CPL ST
26	0K2671C	1	INSUL FRONT C2 D3.4L
27	0J7751	4	SCREW PPHTF #10-16 X 1/2 B
(5)28	022127	1 / 2	NUT HEX 1/4-20 STEEL
29	080318	4	SCREW HHFC M6-1.0 X 25 FTH G8
30	078115A	12	WASHER SELF LOCKING DOME #8-32
31	066760	1	STRIP SEALANT 1/8 X 1
32	0K8973	1	INSULATION
33	0D3059E	2	FOAM,BACK EXHAUST ENCL COVER
(4)34	0E5298L	1	FOAM 300 X 300 THERMAL ACO
35	0F3890A	4	RETAINER INSULATION (740)
36	0F4051C	1	INSULATION DUCT
37	077992	26	NUT HEX LOCK M6-1.0 SS NY INS

NOTES (UNLESS OTHERWISE SPECIFIED):

(1) SHEET METAL PARTS LISTED IN THE BOM TABLE ARE REPRESENTING GENERIC PARTS (NO COLOR)

- MANUFACTURING: FOR CORRECT MATERIAL AND COLOR REFER TO XA BOM.
- CUSTOMER: WHEN ORDERING REPLACEMENT PARTS ENTER BASE NUMBER (FIRST 6 DIGITS ONLY) IN THE SYSTEM FOR CORRECT MATERIAL AND COLOR (FOR REFERENCE SEE GUIDELINE 0H7169).

(2) ENCLOSURE NOTE: PANELS THAT FASTEN TO THE BASEFRAME MUST BE SECURED USING I/N 6 & 7 (THREAD FORMING FASTENERS). ALL PANEL TO PANEL CONNECTIONS TO INCLUDE AT LEAST ONE CONNECTION POINT USING I/N 7 (THREAD FORMING FASTENER).

(3) QTY. REQUIRED FOR STEEL UNITS / QTY. REQUIRED FOR ALUMINUM UNITS.

(4) USED ON 48 & 60 KW UNITS ONLY.

(5) QTY. REQ. FOR 32, 38 & 45KW / QTY. REQ. FOR 36, 45 & 60KW.

(6) USED ON ALUMINUM UNITES ONLY.